

Option D:

- New two sheet ice arena on land that does not have to be purchased
- Operate the Community Center as it is today
- Do nothing with the existing ice arena shell at this time
- No covered turf at this time (could add to project for \$6 Million)

Estimated Cost: \$16.7 Million

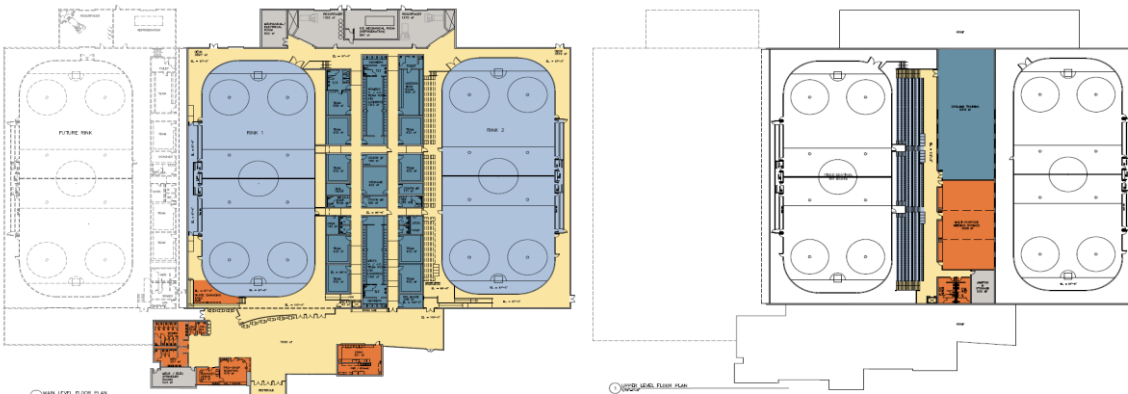

Option E:

- Update the current ice arena refrigeration system only
- Operate the Community Center and ice arena as they are today

Estimated Cost: \$1.75 Million