

Interior Foundation Insulation Systems

Interior Foundation Insulation

Masonry foundation walls shall be drained through the masonry block cores to an approved interior drainage system.

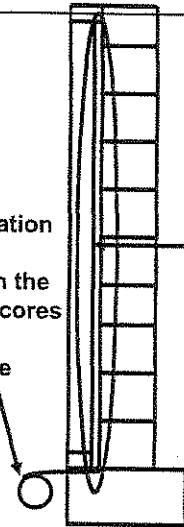

If a frame wall is installed it shall not be in direct contact with the foundation wall, unless that interior side of the foundation wall has been waterproofed.

Interior Foundation Insulation

Masonry foundation walls shall be drained through the masonry block cores to an approved interior drainage system.

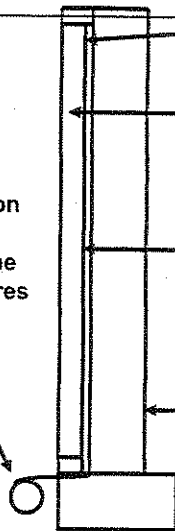

Insulation that meets the requirements for R-Value

Warm Side vapor and Air barrier

If a frame wall is installed it shall not be in direct contact with the foundation wall, unless that interior side of the foundation wall has been waterproofed.

Waterproofing or Damproofing Required in accordance with Chapter 4 of the IRC

Footing

Rigid Interior Foundation Insulation N1102.2.6.8

Installation requirements

- a. Must be in contact with the foundation wall surface
- b. Vertical edges shall be sealed with acoustic sealant
- c. All interior joints, edges, and penetrations shall be sealed against air and water vapor penetration.
- d. Horizontally continuous acoustic sealant between the foundation wall and the insulation at the top of the foundation wall.
- e. Horizontally continuous acoustic sealant between the basement floor and the bottom insulation edge.

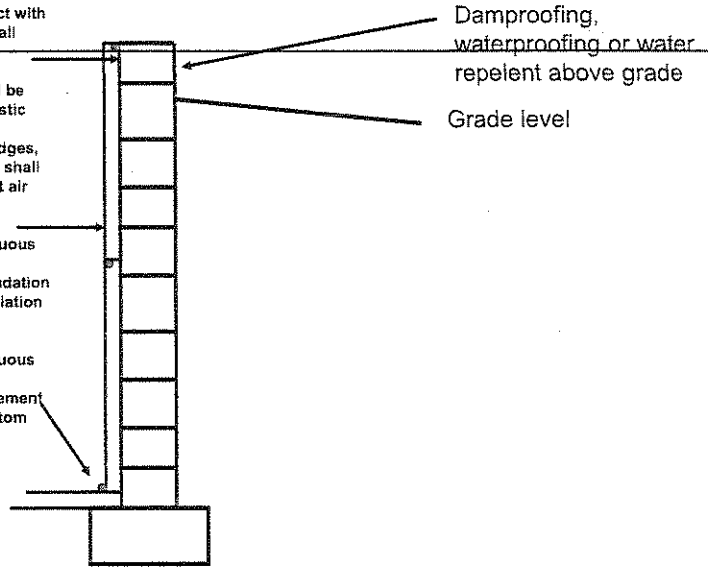

Rigid Interior Foundation Insulation N1102.2.6.8

Installation requirements

The insulation shall not be penetrated by the placement of utilities or by fasteners or connectors used to install a frame wall.

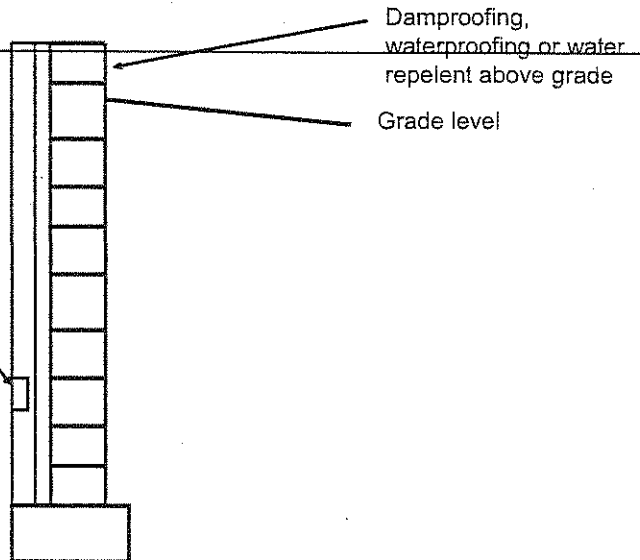

Interior Spray applied insulation

N1102.2.6.9

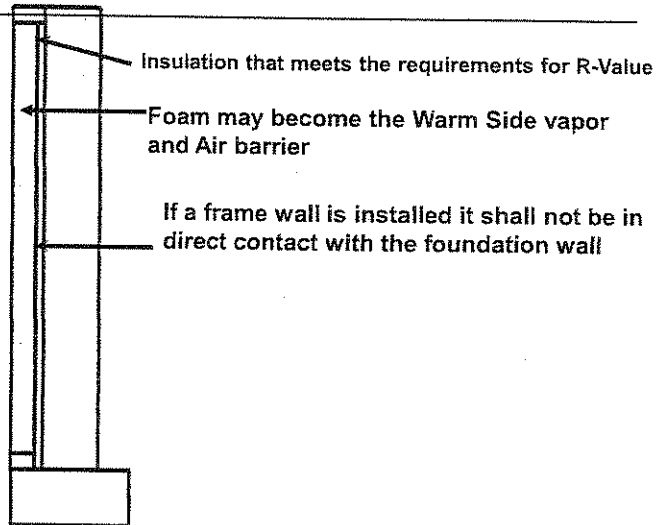

Interior Spray applied interior insulation N1102.2.6.9

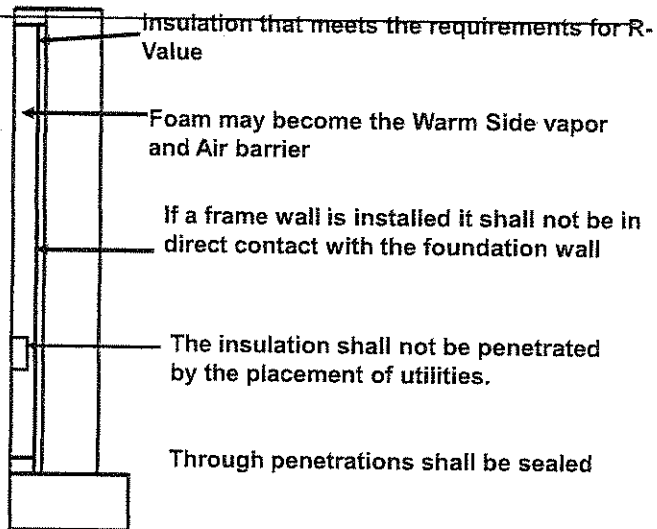

Semi-rigid interior insulation

N1102.2.6.10

- 1. ASTM C1621 with a maximum permeance of 1.1 per inch.
- 2. Must have a minimum density of 1.3 pcf and have a fungal resistance per ASTM C1338.

Semi-Rigid Interior Foundation

Insulation N1102.2.6.8

Installation requirements

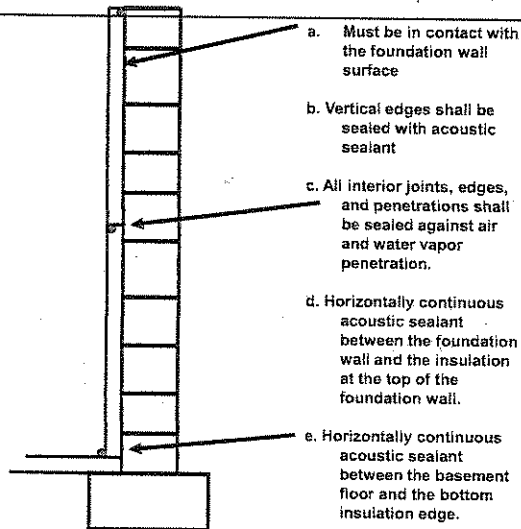

Fiberglass batt interior insulation

1. Waterproofing shall be applied to the entire inside surface of the foundation wall.
2. The top and bottom plates must be air sealed to the foundation Wall surface and the basement floor
3. In addition an air barrier material and vapor retarder material With a minimum permeance of less than 1 perm in accordance with ASTM E 96 procedure A.
 - a. Air sealed to the framing with construction adhesive or equivalent at the top and bottom plates and where adjacent wall is insulated and;
 - b. Air sealed utility boxes and other penetrations and,
 - c. All seams shall be overlapped at least 6 inches and sealed with compatible sealing tape or equivalent.
 - d. Up to R-13 batts are allowed.**

