

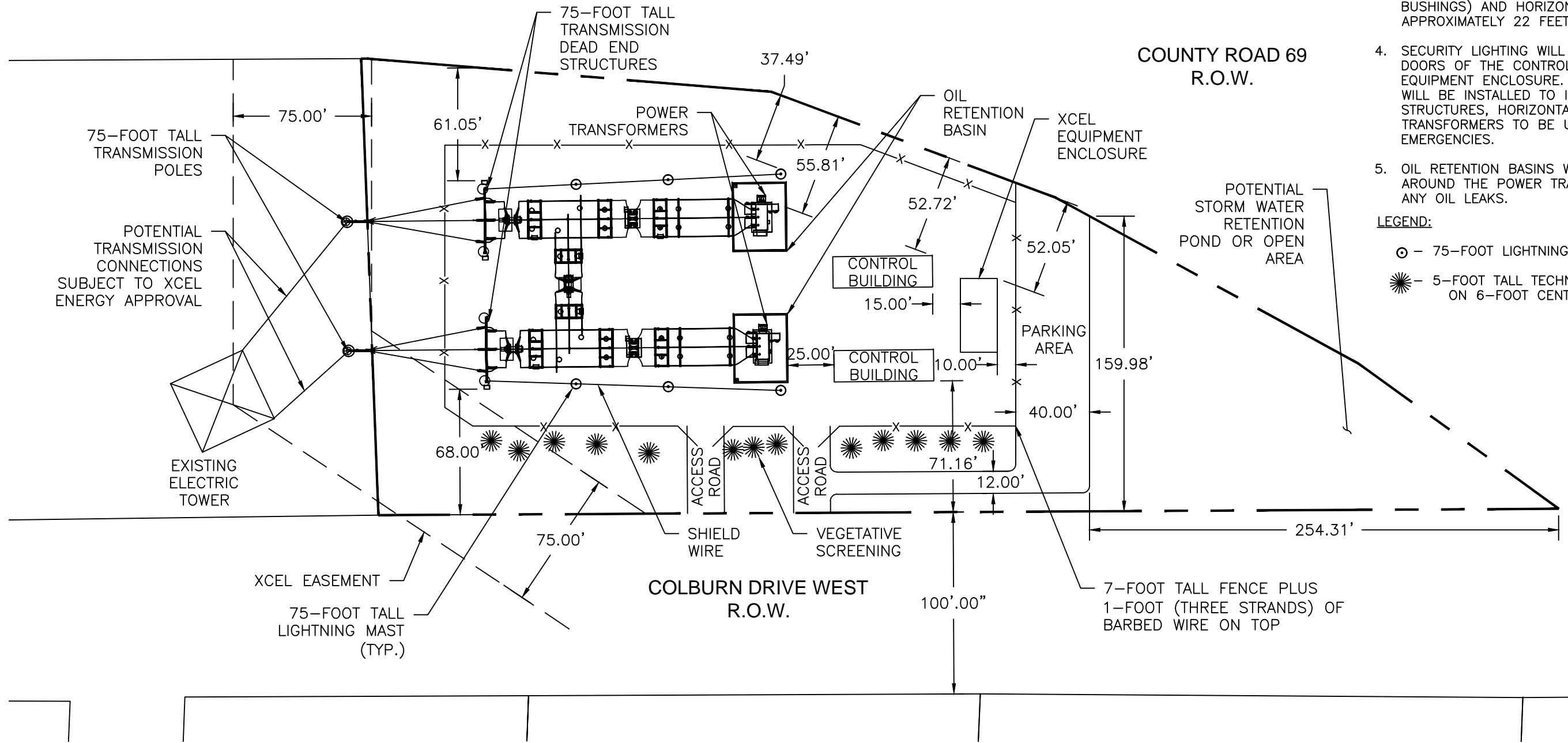

- NOTES:**
1. ALL DIMENSIONS ARE APPROXIMATE.
  2. HEIGHT OF CONTROL BUILDINGS AND XCEL EQUIPMENT ENCLOSURE WILL BE APPROXIMATELY 13 FEET.
  3. HEIGHT OF POWER TRANSFORMERS (INCLUDING BUSHINGS) AND HORIZONTAL BUSES WILL BE APPROXIMATELY 22 FEET.
  4. SECURITY LIGHTING WILL BE INSTALLED OVER THE DOORS OF THE CONTROL BUILDING AND XCEL EQUIPMENT ENCLOSURE. EMERGENCY LIGHTING WILL BE INSTALLED TO ILLUMINATE DEAD-END STRUCTURES, HORIZONTAL BUSES, AND POWER TRANSFORMERS TO BE USED ONLY DURING EMERGENCIES.
  5. OIL RETENTION BASINS WILL BE INSTALLED AROUND THE POWER TRANSFORMERS TO CONTAIN ANY OIL LEAKS.

- LEGEND:**
- ⊙ - 75-FOOT LIGHTNING MAST
  - ☼ - 5-FOOT TALL TECHNY ARBORVITAE ON 6-FOOT CENTERS



PLOT: WALESSA - SAVED: 11/23/2020 3:17 PM WALESSA - FILE: C:\USERS\WALESSA\DOCUMENTS\TEMP\SHAKOPEE\200.DWG : LAYOUT1

DESIGNED	KTF			
DRAWN	PAK			
REV	DATE	CHKD	APPD	REVISION DESCRIPTION
A	2020-11-23	TGP	KTF	PRELIMINARY

**PRELIMINARY**

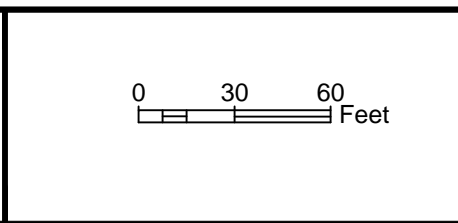

**leidos**  
 Leidos Engineering  
 131 Saundersville Rd., Suite 300  
 Hendersonville, TN 37075  
 (615) 431-3200

SHAKOPEE PUBLIC UTILITIES  
 PROPOSED WEST SUB ON BREEGGEMANN SITE  
 PRELIMINARY CONCEPTUAL LAYOUT  
 2020-11-23

PROJECT NUMBER:	
SHEET OF:	1 1
DRAWING NUMBER:	200.A